



smart shax

The Concept

Lightweight, environmentally sustainable dwelling designed by award-winning architect Ken Latona with the Australian coastal climate in mind.

"Basic amenity plus maximum connection to the environment. It's camping with doors."

The Shacks

The timber design allows the building to rest lightly in its environment upon galvanized steel stirrups. This makes the building particularly suitable for remote, isolated or difficult blocks where traditional buildings would be uneconomic or an environmental insult. The materials selected have low embodied energy, are renewable and reusable.



Off The Grid

In its purest form the smart shax is ideal for that remote block that offers its own special sense of place. It doesn't seek to impose itself on the environment and has been designed to work within it – generating its own power, composting its own waste, collecting its own water removing the need for external connections to electricity, sewer and water. Smart shax enhance the sense of remoteness, and provide environmental self-sufficiency. You are no longer on the grid.

The Size

The (63m²) 15.0 x 4.2 meter wide structure is composed of two 3 x 4m bedrooms, one at either end, a bathroom with separate toilet, and a kitchen living area that opens on to a large 18m² deck. There is also a smaller rear deck and entrance area.

The External Finish

The exterior is finished in stained and oiled shadow clad and has a corrugated metal roof. The gable ends of the roof are glazed to allow constant light, while the bedroom windows are unglazed but shuttered with sliding panels allowing for a complete sense of openness, or privacy. The doors opening to the large deck are glazed, aluminium framed, externally top hung sliders. The kitchen windows are frameless sliders in aluminium tracks. Light and ventilation to the toilet and bathroom are via vented skylights. Hardwood or treated pine decks sit upon treated joists and bearers suspended from the ground on double dipped galvanized piers.

The Fit Out

Basic amenity allows for high quality finishes that require low maintenance. All the floors are screen finished polished timber. The natural oil finish ply ceilings sit above the rafters giving an exposed oiled finished truss. The remaining walls are paint finish plasterboard. All internal doors are hollow core and can be either cavity sliders or hung. The front door is solid core and dead latched.

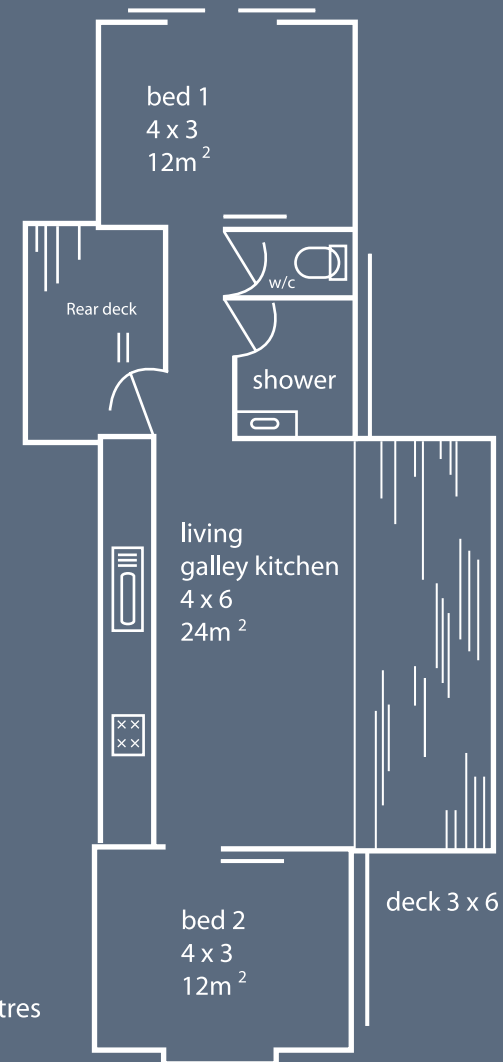

smart shax
15.0 x 4.2 metres
floor lay out